

Above Slab:

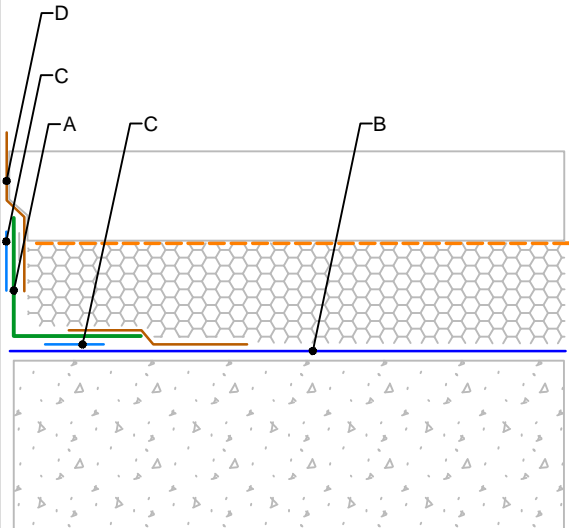

Below Slab:

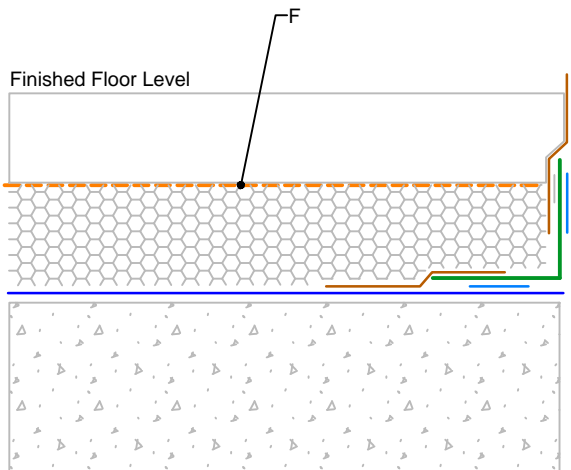
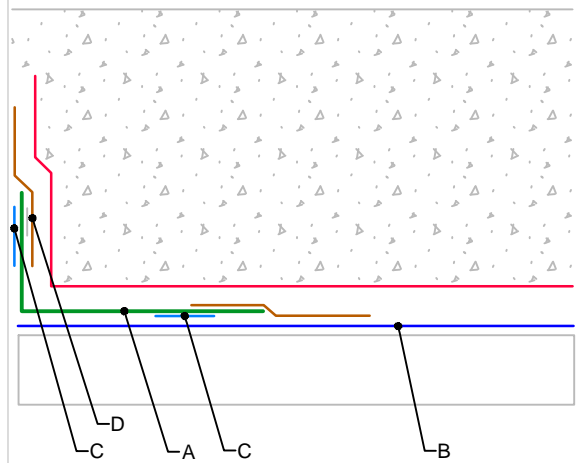
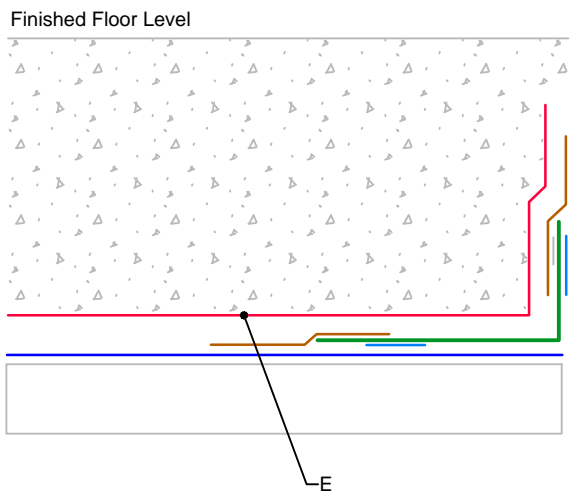

Materials :-

Refer to Cordek technical data sheets for full detailed material specification

- A. Cordek Preformed Top Hat
- B. Cordek Radon Gas Membrane
- C. Cordek Double Sided Jointing Tape
- D. Cordek GR Jointing Tape
- E. Cordek Correx Protection Board
- F. VCL / Floor Finishes by others

Notes :-

- This detail is issued for guidance purposes only, with final approval required from the designer
- Do not scale from drawing, use dimensions provided
- All laps and junctions must be fully sealed with appropriate welding techniques or jointing system
- The intended construction sequence should be considered prior to selection of the appropriate Cordek standard detail to ensure that installation is practical and achievable
- In line with industry guidance and good practice, a sub-floor venting layer should be considered - please consult Cordek for further advice
- In accordance with BS8102:2009, should hydrostatic water pressure be a risk, additional waterproofing methods should be considered.

Standard Detail



Tel : 01403 799600

Email : techsupport@cordek.com

Drg. Title: Cordek Radon Protection System
Typical Pipe Penetration Detail

Drawn: SC

Date: 17.04.14

Scale: NTS

Drg. No. ENG/GP/MEM/RAD/16

Rev. -